

vtech®

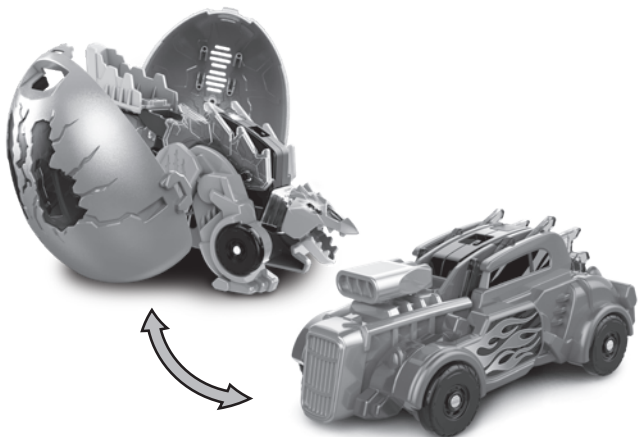

Instruction Manual

SWITCH & GO

HATCH & ROLLAR EGG™
STEGOSAURUS HOT ROD



Exit Try-Me Mode

Before playing, you will need to exit the battery-saving Try-Me Mode. Slide the Power Switch from Dino Mode  to Vehicle Mode  to exit Try-Me Mode and enter normal play mode.

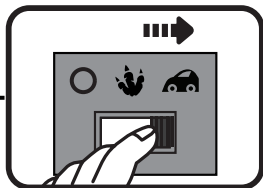
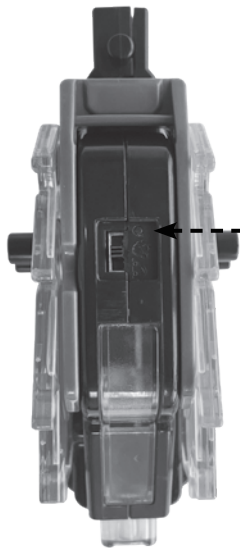

Step 1

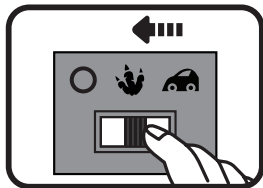

Step 2

INTRODUCTION

Thank you for purchasing **Switch & Go Dinos® Hatch & Roaar Egg™ Stegosaurus Hot Rod** by **VTech®**! Assemble this awesome Stegosaurus, and then switch it in a few simple steps into a powerful Hot Rod! Enjoy dino roars and cool engine sound effects along with flashing lights as you play! It's stomping time!

Power Switch (with Off/
Dino/Vehicle Modes)

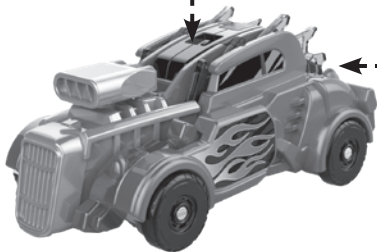
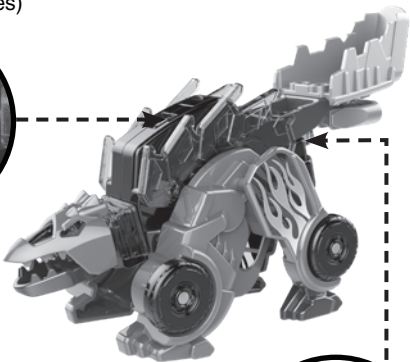

Talk Button

INCLUDED IN THE PACKAGE

- **Switch & Go® Hatch & Roaaar Egg™ Stegosaurus Hot Rod** (12 Build Pieces)
- 2 Eggshell Halves
- 1 Display Stand
- Quick Start Guide

WARNING

All packing materials such as tape, plastic sheets, packaging locks, removable tags, cable ties, cords and packaging screws are not part of this toy, and should be discarded for your child's safety.

NOTE

Please save this manual as it contains important information.

ATTENTION

Pour la sécurité de votre enfant, débarrassez-vous de tous les produits d'emballage tels que rubans adhésifs, feuilles de plastique, attaches, étiquettes, cordons et vis d'emballage. Ils ne font pas partie du jouet.

NOTE

Il est conseillé de sauvegarder ce manuel car il comporte des informations importantes.

Unlock the Packaging Locks

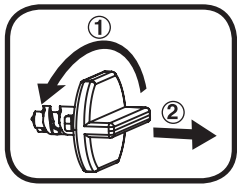

- ① Turn the packaging locks counterclockwise several times.
- ② Pull out the packaging locks and discard.

GETTING STARTED

Exit Try-Me Mode:

The product is in try-me mode in the packaging. To exit try-me mode, just slide the Power Switch from Dino Mode to Vehicle Mode.



WARNING:

Adult assembly required for battery installation.

Keep batteries out of reach of children.



ATTENTION :

Les piles ou accumulateurs doivent être installés par un adulte.

Tenir les piles ou accumulateurs hors de portée des enfants.

Battery Removal and Installation

1. Make sure the Core Unit is turned **Off**.
2. Find the battery cover located on the bottom of the unit, use a screwdriver to loosen the screw and then open the battery cover.
3. Remove old battery by pulling up on one end of each battery.
4. Install 1 new AAA (AM-4/LR03) battery following the diagram inside the battery box. (For best performance, alkaline batteries or fully charged Ni-MH rechargeable batteries are recommended.)
5. Replace the battery cover and tighten the screw to secure.

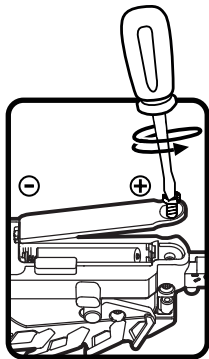

IMPORTANT: BATTERY INFORMATION

- Insert batteries with the correct polarity (+ and -).
- Do not mix old and new batteries.
- Do not mix alkaline, standard (carbon-zinc) or rechargeable batteries.
- Only batteries of the same or equivalent type as recommended are to be used.
- Do not short-circuit the supply terminals.
- Remove batteries during long periods of non-use.
- Remove exhausted batteries from the toy.
- Dispose of batteries safely. Do not dispose of batteries in fire.

RECHARGEABLE BATTERIES

- Remove rechargeable batteries (if removable) from the toy before charging.
- Rechargeable batteries are only to be charged under adult supervision.
- Do not charge non-rechargeable batteries.

IMPORTANT : INFORMATIONS CONCERNANT LES PILES

Les piles fournies avec le produit permettent de tester le jouet en magasin mais ne sont pas des piles longue durée.

- Mettre en place les piles ou les accumulateurs en respectant les polarités + et –.
- Ne pas mélanger des piles ou des accumulateurs neufs avec des usagés.
- Ne pas mélanger différents types de piles : alcalines, zinc-carbone et rechargeables.
- Seules des piles du type recommandé doivent être utilisées.
- Ne pas mettre les bornes d'une pile ou d'un accumulateur en court-circuit (en reliant directement le + et le –).
- Retirer les piles ou les accumulateurs en cas de non-utilisation prolongée.
- Enlever les piles ou les accumulateurs usagés du jouet.
- Ne les jeter ni au feu ni dans la nature.

PILES RECHARGEABLES :

- Enlever, lorsque c'est possible, les accumulateurs du jouet pour les recharger.
- Les accumulateurs ne doivent être chargés que sous la surveillance d'un adulte.
- Ne pas tenter de recharger des piles non rechargeables.

ASSEMBLY INSTRUCTIONS

1. Identify the following pieces for assembly:



EGGSHELL BACK



01 CORE UNIT



02



03



04



05



06



07



08



09



10



11



12



STAND

2. Assemble Sections A-E as shown below and then follow steps 3 and 4 to combine those pieces.

A

FLIP TAIL TO THE BACK/
CONNECT JAW TO THE BODY

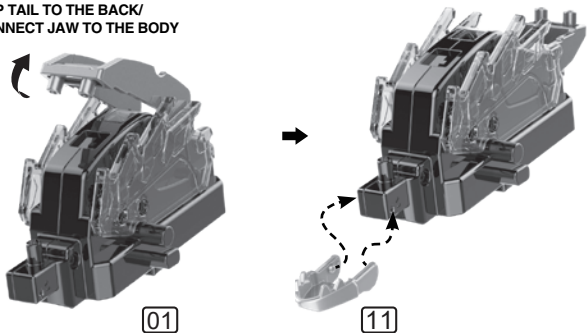

B

HEAD

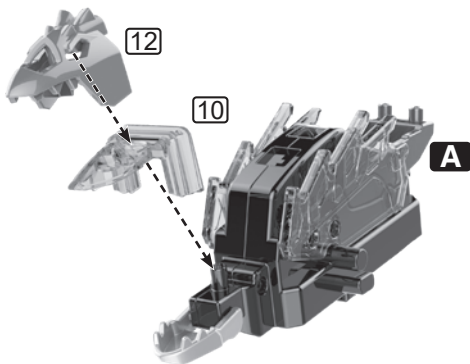

C

RIGHT LEGS

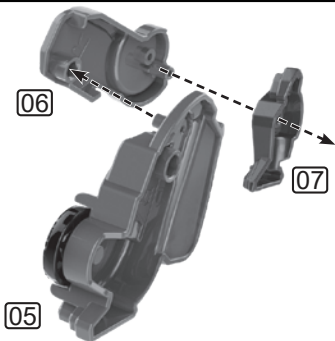
**D**

LEFT LEGS

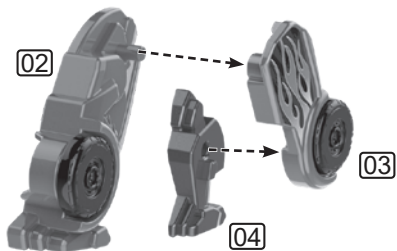
**E**

TAIL

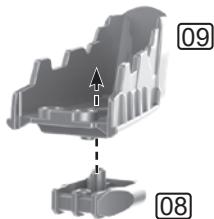

3. Combine the assembled legs and the tail to the body.

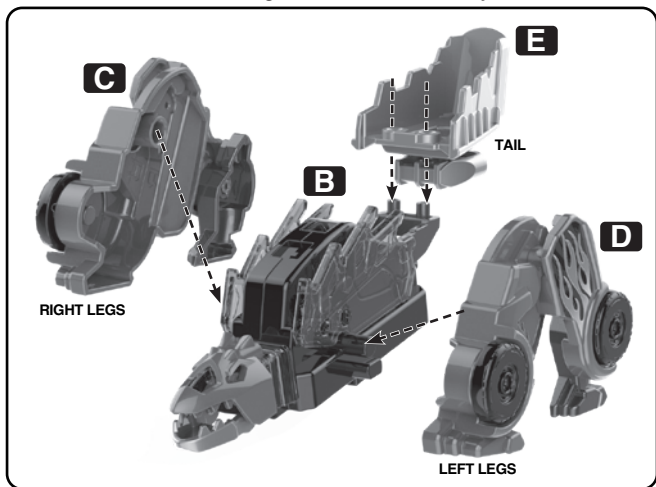

4. The dino assembly is now complete.

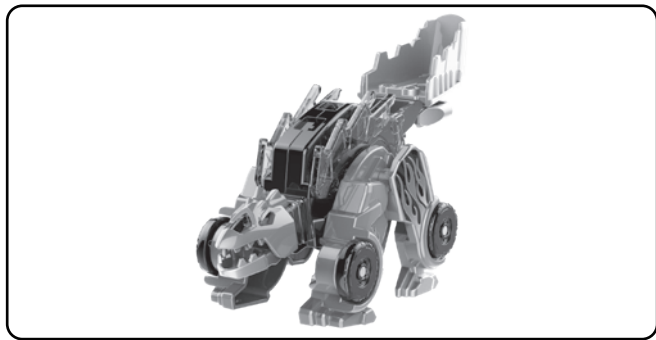

5. After the Dino is assembled, follow the below illustrations to connect the stand piece with the Dino and the eggshell.

ATTACH THE STAND

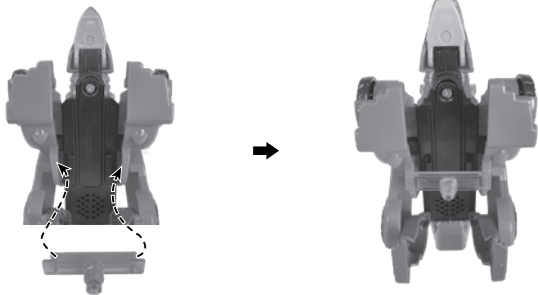

INSERT INTO THE SHELL

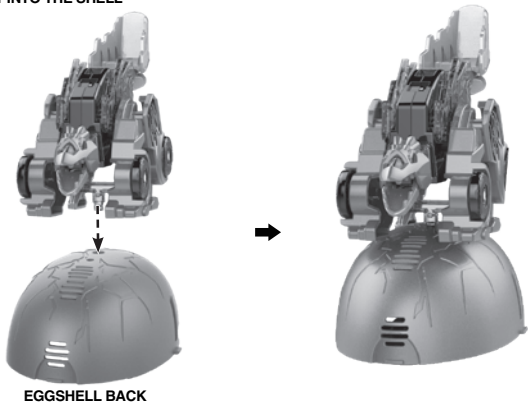

EGGSHELL BACK

Note: If you would like to switch the Dino into Vehicle Mode, the stand connection piece needs to be removed.

HOW TO SWITCH

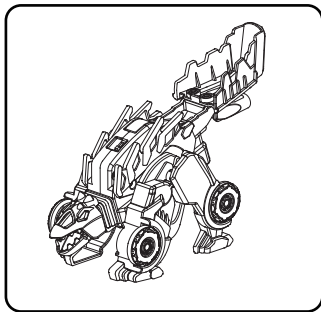

1. Begin in Dino Mode.

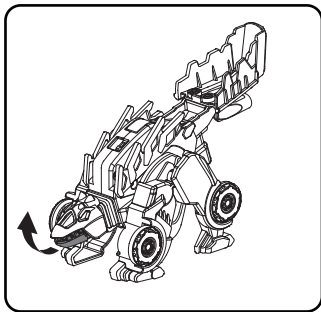

2. Close the Dino's mouth.

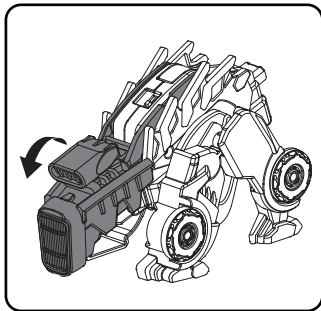

3. Flip the tail up toward the Dino's head.

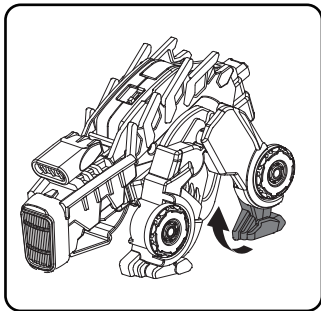

4. On both sides, rotate the feet up toward the Dino's body.

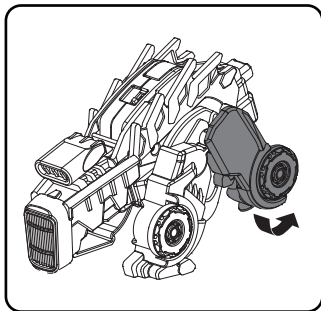

5. On both sides, rotate the back legs to align with the front legs.

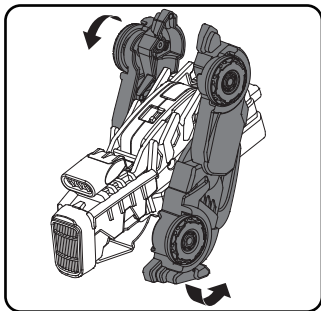

6. On both sides, rotate the aligned legs to align with the vehicle body.

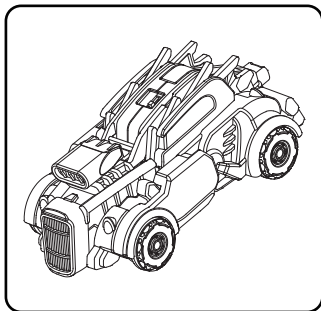



7. The Dino is now in Vehicle Mode. Slide the Power Switch to Vehicle Mode to play Vehicle responses.

Note: To switch from Vehicle Mode to Dino Mode, follow the above steps in reverse order.

PRODUCT FEATURES

1. POWER SWITCH

Slide the **Power Switch** to Dino Mode () or Vehicle Mode () to play. Slide the **Power Switch** to the **Off** position to turn the unit **Off**.



2. TALK BUTTON

Press the **Talk Button** to hear fun phrases and cool dinosaur sounds in Dino Mode, or to hear fun phrases and great vehicle sounds in Vehicle Mode.

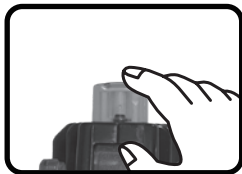

3. AUTOMATIC SHUT-OFF

To preserve battery life, **Switch & Go Dinos® Hatch & Roaaar Egg™ Stegosaurus Hot Rod** will automatically shut off after approximately 10 seconds without input. The unit can be turned on again by pressing the **Talk Button**.

Note: If the unit powers down or if the light flashes 3 times without sounds during play, please install a new battery.

CARE & MAINTENANCE

1. Keep the unit clean by wiping it with a slightly damp cloth.
2. Keep the unit out of direct sunlight and away from any direct heat sources.
3. Remove the battery if the unit will not be in use for an extended period of time.
4. Do not drop the unit on hard surfaces and do not expose the unit to moisture or water.

TROUBLESHOOTING

If for some reason the unit stops working or malfunctions, please follow these steps:

1. Turn the unit **Off**.
2. Interrupt the power supply by removing the battery.
3. Let the unit stand for a few minutes, then replace the battery.
4. Turn the unit **On**. The unit should now be ready to use again.
5. If the unit still does not work, install a new set of battery.

IMPORTANT NOTE:

If the problem persists, please call our **Consumer Services Department** at **1-800-521-2010** in the U.S., **1-877-352-8697** in Canada, or by going to our website **vtechkids.com** and filling out our **Contact Us** form located under the **Customer Support** link. Creating and developing VTech products is accompanied by a responsibility that we take very seriously. We make every effort to ensure the accuracy of the information, which forms the value of our products. However, errors sometimes can occur. It is important for you to know that we stand behind our products and encourage you to contact us with any problems and/or suggestions you might have. A service representative will be happy to help you.

NOTE

This equipment has been tested and found to comply with the limits for a Class B digital device, pursuant to Part 15 of the FCC Rules. These limits are designed to provide reasonable protection against harmful interference in a residential installation. This equipment generates, uses and can radiate radio frequency energy and, if not installed and used in accordance with the instructions, may cause harmful interference to radio communications. However, there is no guarantee that interference will not occur in a particular installation. If this equipment does cause harmful interference to radio or television reception, which can be determined by turning the equipment off and on, the user is encouraged to try to correct the interference by one or more of the following measures:

- Reorient or relocate the receiving antenna.
- Increase the separation between the equipment and receiver.
- Connect the equipment into an outlet on a circuit different from that to which the receiver is connected.
- Consult the dealer or an experienced radio/TV technician for help.

CAUTION

Changes or modifications not expressly approved by the party responsible for compliance could void the user's authority to operate the equipment.

Supplier's Declaration of Conformity

47 CFR § 2.1077 Compliance Information

Trade Name: VTech®
Model: 5690
Product Name: Switch & Go® Hatch & Roaaar Egg™
Stegosaurus Hot Rod
Responsible Party: VTech Electronics North America, L.L.C.
Address: 1156 W. Shure Drive, Suite 200
Arlington Heights, IL 60004
Website: vtechkids.com

THIS DEVICE COMPLIES WITH PART 15 OF THE FCC RULES. OPERATION IS SUBJECT TO THE FOLLOWING TWO CONDITIONS: (1) THIS DEVICE MAY NOT CAUSE HARMFUL INTERFERENCE, AND (2) THIS DEVICE MUST ACCEPT ANY INTERFERENCE RECEIVED, INCLUDING INTERFERENCE THAT MAY CAUSE UNDESIRE OPERATION.

CAN ICES-003(B)/NMB-003(B)



WARNING:

CHOKING HAZARD—Small parts.
Not for children under 3 yrs.



AVERTISSEMENT:

RISQUE DE SUFFOCATION—Petites
pièces. Ne convient pas aux enfants
de moins de 3 ans.

**Visit our website for more
information about our products,
downloads, resources and more.**

vtechkids.com
vtechkids.ca

Read our complete warranty policy online at
vtechkids.com/warranty
vtechkids.ca/warranty

